



# Mondo Marine SF 40

by Mondo Marine and Luca Vallebona for SF Yachts

**M**ondo Marine returned to the key showcase event of the Dubai International Boat Show again this year, and once again won another in a long line of top-level orders. A contract for a new luxury motor yacht was signed through the commercial brokerage of SF Yachts, a yacht services company based in Dubai that specialises in consultancy and management as well as brokerage and charter. It is also the Italian shipyard's agent for sales in the Middle East.

The vessel that was sold recently belongs to a new series of motor yachts named the SF Line. This line was developed thanks to an innovative initiative by SF Yachts with the aim of offering an ever more up-to-date product in terms of technology and aesthetics, focusing on the cutting edge in order to meet the growing requirements that are presently a trend on the world market.

This prestigious new series, exclusively produced by Mondo Marine, consists of motor yachts with semi-displacement hulls. To date, the SF Line comprises three models: the entry level SF 30 with a length of 32.70 metres, equivalent to 107 feet, the mid range SF 35 with a length of 37.50 metres, equivalent to 123 feet, and finally the top of the range SF 40, which has a length of 41.50 metres, or 136 feet. Built entirely in light aluminium alloy for both the hull and the superstructure, all the motor yachts in the SF Line are based on naval architecture developed in-house by the Italian shipyard with its technical team, Mondo Marine Engineering.

The exterior and interior design and the interior decoration were all developed by Luca Vallebona on behalf of SF Yachts, and he also prepared numerous alternative proposals in several different versions for each individual model in the new series. However, the first yacht in the series sold by SF Yachts is now already in the advanced phases of construction, ready to become the first hull of the SF 40 model when it is launched.

We now present a preview of it in these pages of our quarterly magazine. The small amount of information released to date by the Italian shipyard does not include the delivery date of the new motor yacht, but this ought to be towards the end of summer next year.

As with all the models in the SF Line, the new SF 40 has a pleasingly modern, elegant exterior design, with balanced volumes and precise, clean geometric lines that flow harmoniously and eschew rigidity.

In addition, the monochrome livery provides a touch of class in itself, with a single shade of white paint for the hull and superstructure, almost referring back directly to the classic transoceanic vessels that cruised the oceans in the early years of the 20th century.

Further reinforcing this charming, timeless look of days gone by is undoubtedly the unusual slant of the prow, which is almost identical to that of the unmistakable luxury yachts owned by high finance and industry tycoons.

From the yacht's historical inspiration to its futuristic focus, the final look of the vessel is that of a gentleman's yacht entirely reinterpreted from a contemporary perspective. The sophisticated, exclusive interior design is equally contemporary, designed in a simple, clean style that is not remotely minimalist, playing on the refinement of the details and the elegance of the combinations.

The design scheme for the interiors is comparable to that of a panoramic urban loft, full of light of course, but also offering a stunning view of the sea, and arranged in a practical, functional way in terms of spaces and access routes. ➤





*A pleasingly modern and elegant design, characterized by balanced volumes and precise, clean-cut lines that are absolutely not rigid but harmoniously fluent.*

Similarly, the yacht has been carefully designed to create a coherent ensemble in terms of style and decoration, forming a flawless example of an aesthetic continuum expressed through simple luxury and measured elegance.

Each element is closely linked to the others in masterful juxtapositions of shapes, materials and colours that are well coordinated to achieve a genuinely sublime effect of warm, domestic hospitality throughout the interiors, fully immersed in an atmosphere of refined simplicity.

Light, rather calm colour tones dominate throughout, and were the preferred choice for both hard materials such as wood and marble, used for the cladding of surfaces, walls and floors, and soft materials such as leather and fabrics, used for beds, chairs and sofas. A few striking dark tones have also been selected and used occasionally to provide a pleasing contrast, standing out strongly to highlight architectural elements such as frames and storage units, as well as loose furniture such as tables large and small.

The magical final touch of a skilful lighting system completes this solution for the interiors, ably mixing natural and artificial light to create a refined choreography of light through a lively dialogue between transparent surfaces and light fixtures. ➤

# INTERIOR



Mondo Marine SF 40



The layout of the new yacht has been designed with maximum attention to functionality and rationality to offer hugely generous, practical exterior and interior spaces during both cruising on the open ocean and long stays at anchor. Two different functional areas have been laid out on the fly deck: one is completely open, intended as a sunbathing area with sun pads and a custom pool, while the other is fully covered by a large hard top, intended for lounging and alfresco dining. The respective areas are laid out with sofa seating and a dining table. The raised pilot house space is located between the fly deck and the upper deck, with a pilot's chair and instrument panel. On the upper deck, or rather the Owner's deck as it is fully occupied by the Owner's suite, there is a terrace to aft, partially covered by the overhanging deck above. This features a lounge area with sofa seating, a bar area and an alfresco dining area with

a dining table. Inside, the panoramic sky lounge is intended for use as a television saloon, laid out with sofas around coffee tables, while alongside it there is a pantry and a day head. A small lobby leads to the master stateroom, laid out on two staggered levels: the upper level has a double bed and two desks / dressing tables, while the lower level is a huge single space including wardrobes and chaises longues for relaxation as well as a bathroom with a tub and shower. On the main deck, the aft wheelhouse is laid out as a lounge area with sofa seating and chairs arranged around a coffee table. Inside, after an entrance area with small storage units, the saloon is a large single space conceptually subdivided into two different functional areas: one living area with a coffee table surrounded by chairs and sofas, and a dining area with a dining table and small storage units.

*The design scheme for the interiors is comparable to that of a panoramic urban loft, but with a stunning view of the sea. It is conceived to form a stylistically consistent whole.*



▲▼ The Owner's cabin



▲▼ The Owner's cabin





## Mondo Marine SF 40

*Contemporary, the sophisticated, exclusive interior design is in a simple, clean but not remotely minimalist style, the play being on refined details and elegant combinations.*

The pantry and galley are located amidships alongside the crew mess / lounge, while a small lobby with a day head and laundry room provides access to the staircase down to the deck below and the guest quarters. The lower deck features four guest staterooms, each with a wardrobe and an en suite bathroom with separate shower cubicle: two of these staterooms have twin beds while the other two each have a double bed, a desk / dressing table and an armchair.

Finally, the crew quarters are located in the forward section of the deck, featuring four cabins each with a wardrobe and a bathroom with separate shower cubicle: one of these is the captain's cabin, with a double bed and a desk, and the other three are for the sailors, each with two bunk beds.

*Flaviano Perelli*

▼ The VIP cabin



▲▼ The VIP cabin





*Layout. The Owner's suite, located forward, is spread over two staggered levels: on the upper level, the master stateroom, on the lower level a single space including the wardrobe and the bathroom.*

## Mondo Marine SF 40

Profile



Fly deck

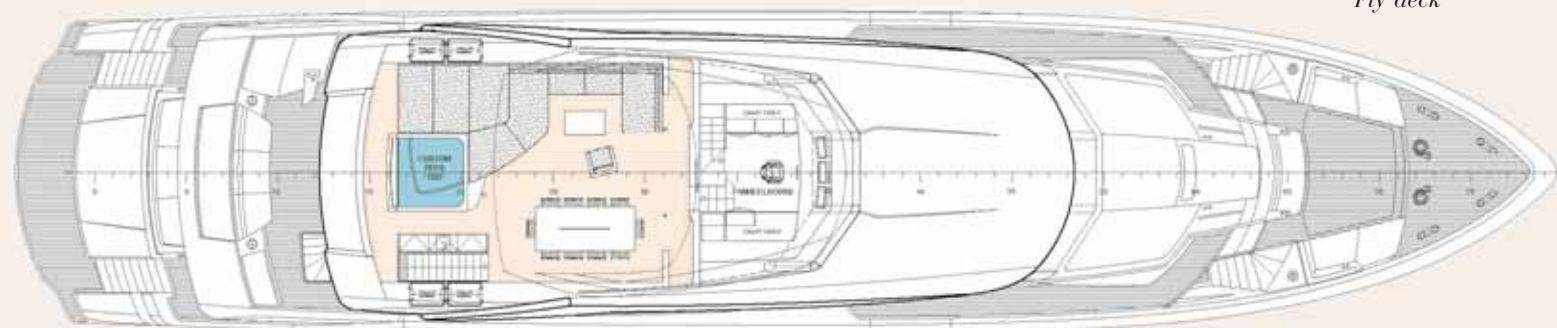

Owner deck

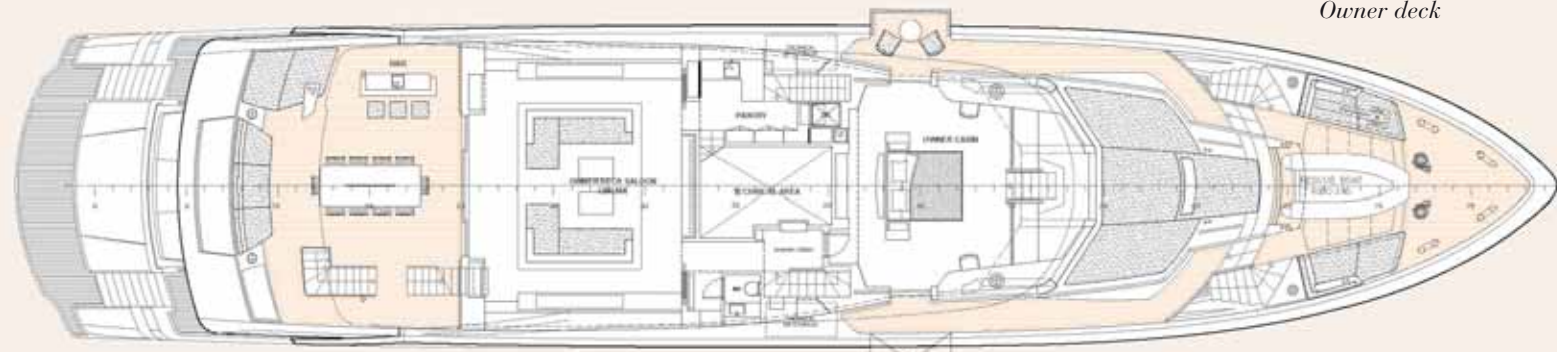

Main deck



Lower deck



### TECHNICAL SPECIFICATIONS

Hull	Light Alloy
Superstructure	Light Alloy
LOA	41.50 m / 131'20" ft
BOA	8.80 m / 28'10" ft
Draft extreme	2.20 m / 7'20" ft
Main engines	2 x MTU 12V 2000 M72
Maximum power	2 x 1,080 kW 2 x 1,450 HP at 2,250 rpm
Range at 12 knots	4,000 nautical miles
Cruising speed	15 knots
Fuel	1 x 32767 litres
Water	1 x 14000 litres
Classification	RINA class register C $\otimes$ HULL • Mach Ych Unrestricted Navigation
Naval architecture	<b>Mondo Marine Engineering</b>
Exterior Designer	<b>Luca Vallebona for SF Yachts</b>
Interior Designer	<b>Luca Vallebona for SF Yachts</b>
Builder	<b>Mondo Marine</b> <a href="http://www.mondomarinemc.mc">www.mondomarinemc.mc</a> <a href="mailto:info@mondomarinemc.mc">info@mondomarinemc.mc</a>